

BLUE STRIPE® Link Stick

Swivel Eye, Hook & Swivel Eye, Hot Stick Operable Hook & Swivel Eye

BLUE STRIPE® Link Sticks are available in various configurations. The Swivel Eye, Hook & Swivel Eye, and Hot Stick Operable Hook & Swivel Eye are load rated to 4,000 lbs. and feature 1.25" diameter foam filled fiberglass.

Applications include:

- Insulating strap hoists while tensioning lines.
- Insulating bucket jib while lifting or pulling lines.



BLUE STRIPE® Link Stick with Swivel Eye

Item Number :	Ends:	Size:	
USLS-006-SWVL	Swivel Eye Ends	6 in	.2 m
USLS-012-SWVL		12 in	.3 m
USLS-015-SWVL		15 in	.4 m
USLS-018-SWVL		18 in	.5 m
USLS-024-SWVL		24 in	.6 m



BLUE STRIPE® Link Stick with Safety Hook & Swivel Eye

Item Number :	Ends:	Size:	
USLS-006-HOOK	Safety Hook & Swivel Eye	6 in	.2 m
USLS-012-HOOK		12 in	.3 m
USLS-015-HOOK		15 in	.4 m
USLS-018-HOOK		18 in	.5 m
USLS-024-HOOK		24 in	.6 m



BLUE STRIPE® Stick Operable Safety Hook & Swivel Eye

Item Number :	Ends:	Size:	
USLS-006-STOP	Hot Stick Operable Safety Hook & Swivel Eye	6 in	.2 m
USLS-012-STOP		12 in	.3 m
USLS-015-STOP		15 in	.4 m
USLS-018-STOP		18 in	.5 m
USLS-024-STOP		24 in	.6 m

Next-level Performance

Removes the complexity from operating a safety hook with a hot stick.

CNC Machined Parts

Machined parts offer a higher quality than cast metal, allowing for longer lasting operation.

Uniquely Designed

Patent Pending design automatically charged and "locks" into place when aligned with the hook.

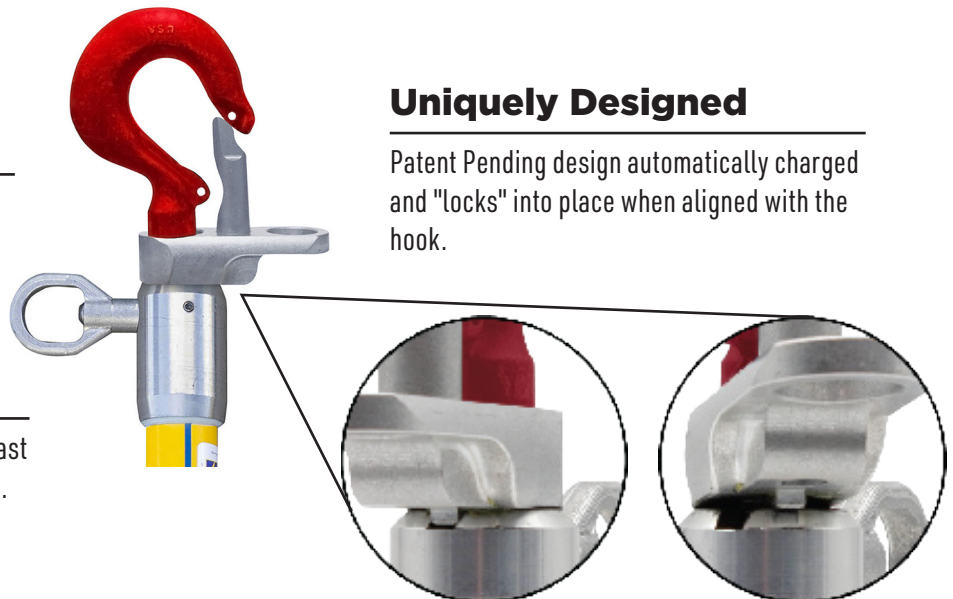

BLUE STRIPE® Link Stick

Crossarm & Swivel Eye

The BLUE STRIPE® Link Stick with Crossarm & Swivel Eye is load rated to 1,500 lbs., constructed from 1.25" diameter foam filled fiberglass and can be installed or removed via hot stick. The BLUE STRIPE® Link Stick with Crossarm & Swivel Eye has a 5" hook that fits crossarms up to 3.75" x 4.75".

Applications include:

- Insulating strap hoists while tensioning lines.
- Fitting directly around crossarms, eliminating the need to install a sling in order to create an attachment point.



Item Number: USLS-022-XARM
22" HOOK & SWIVEL EYE END

BLUE STRIPE® Link Stick

Pigtail Hook & Swivel Eye, Heavy Duty Pigtail & Swivel Eye

The BLUE STRIPE® Link Stick with Pigtail and Swivel Eye features 1.25" diameter foam filled fiberglass, and can be installed or removed via hot stick.

Applications include:

- Pulling and lifting line spans for creating work clearance or repositioning phases.
- Allows quick installation onto line without needing to operate a latch.
- Quicker installation than a regular hook in situations where a true positive lock is not necessary.



- Load rated to 2,000 lbs.
- Accommodates wires up to 1" diameter.



- Load rated to 3,500 lbs.
- Accommodates wires up to 1.5" diameter.

Item Number :	Ends:	Size:	
USLS-006-PIG	Pig Tail & Swivel Eye	6 in	.2 m
USLS-012-PIG		12 in	.3 m
USLS-015-PIG		24 in	.6 m
USLS-018-PIG		36 in	.9 m
USLS-024-PIG		48 in	1.2 m

Item Number :	Ends:	Size:	
USLS-006-HOG	Heavy Duty Pigtail & Swivel Eye	6 in	.2 m
USLS-012-PIG		12 in	.3 m
USLS-015-PIG		24 in	.6 m
USLS-018-PIG		36 in	.9 m
USLS-024-PIG		48 in	1.2 m

Our BLUE STRIPE® Link Sticks are available in custom lengths. Please contact customer service at (828)-323-8914 for more information.