

# COMPOSITE DEADEND INSULATOR

FOR APPLICATIONS UP TO 485 kV BIL

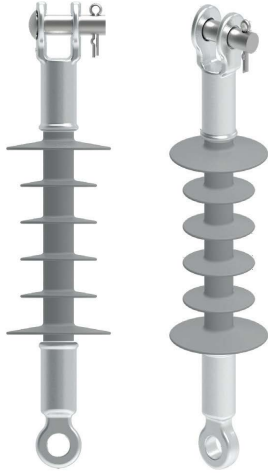

**COMPACT, ROBUST SILICONE INSULATORS  
ENGINEERED FOR RELIABILITY AND  
CONSISTENT, DURABLE PERFORMANCE**

## APPLICATIONS

- Overhead Power Lines

## RELEVANT STANDARDS AND TESTING

- Compliant with ANSI C29.13
- Manufactured in an ISO 9001-accredited facility

## KEY FEATURES

- 15,000 lb tension rating (SML)
- Wide selection of metal end fittings
- Reliable tensile performance
- Lightweight for easier installation
- Shed design reduces insulator length per kV rating
- Shock and vibration-resistant
- Excellent tracking and erosion resistance

TE Connectivity (TE) offers a comprehensive range of silicone suspension and tension insulators for overhead line applications of up to 485 kV BIL.

Our portfolio includes various lengths, creepage configurations, and metal end fittings to meet diverse application requirements. The compact design features a uniform shed profile, helping to ensure optimal flash-over performance in polluted environments while maintaining minimal insulator length.

These insulators are manufactured from high-quality silicone, a hydrophobic material known for its resistance to tracking and erosion, delivering consistent technical performance across different climatic and pollution conditions. All products are backed by a reliable production process to help ensure durability and long-term service.

## PRODUCT SPECIFICATIONS (WITH CAST END FITTINGS)

PART NUMBERS	DESCRIPTION	ANSI CLASS	CREE -PAGE DIST. in (mm)	DRY ARC DIST. in (mm)	LOW FREQUENCY FLASH -OVER DRY kV	LOW FREQUENCY FLASH -OVER WET kV	POSITIVE CRITICAL IMPULSE FLASH -OVER kV	RADIO INFLUENCE TEST VOLT. kV	MAX RIV $\mu$ V	SML lbf (kN)	TORSION -AL LOAD lbf-ft (Nm)	SECTION LENGTH L in (mm)	APPROX. WEIGHT (kg)	STD PACK QTY (pcs)
EP0246-000	TE-DS15-CT-01	DS-15	15.3 (390)	7.8 (200)	100	85	150	15	<10	15,730 (70)	35 (48)	13 (330)	0.93	36
EP0247-000	TE-DS28-CT-01	DS-28	25 (635)	12.2 (310)	130	100	190	20	<10	15,730 (70)	35 (48)	17.6 (447)	1.05	18
EP0248-000	TE-DS35-CT-01	DS-35	32.2 (820)	15.7 (400)	175	155	250	30	<10	15,730 (70)	35 (48)	21 (534)	1.14	18
EP0249-000	TE-DS46-CT-01	DS-46	37.2 (945)	18.11 (460)	200	185	280	30	<10	15,730 (70)	35 (48)	23.30 (592)	1.2	18
EP0250-000	TE-DS69-CT-01	DS-69	49.2 (1250)	23.81 (605)	245	225	360	45	<10	15,730 (70)	35 (48)	29 (737)	1.35	18

**End Fitting** - Clevis per ANSI C29.13 (Cast\*)  
Tongue per ANSI C29.13 (Cast\*)

**Round Head Pin** - Galvanized Pin

**Split Pin** - Stainless Steel

**SML (Specified Mechanical Load)** - 15000 Lbs

**Routine Test Load** - 7,500 Lbs

\*Additional end fittings (e.g. Ball, Socket, and others) are available on request.

### Naming Convention

<b>TE-</b>	<b>XXXX-</b>	<b>XX -</b>	<b>XX</b>
Company Designation	ANSI Class	End Fitting	End Fitting Type/ Customisation

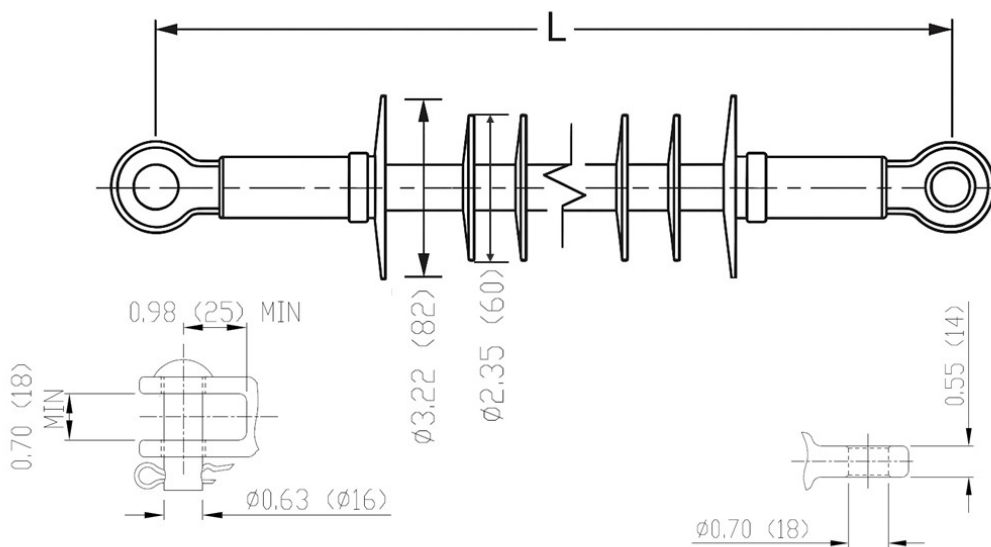

Dimensions inch (mm)

## PRODUCT SPECIFICATIONS (WITH FORGED END FITTINGS)

PART NUMBERS	DESCRIPTION	ANSI CLASS	CREE -PAGE DIST. in (mm)	DRY ARC DIST. in (mm)	LOW FREQUENCY FLASH -OVER DRY kV	LOW FREQUENCY FLASH -OVER WET kV	POSITIVE CRITICAL IMPULSE FLASH -OVER kV	RADIO INFLUENCE TEST VOLT. kV	MAX RIV $\mu$ V	SML lbf (kN)	TORSION -AL LOAD lbf-ft (Nm)	SECTION LENGTH L in (mm)	APPROX. WEIGHT (kg)	STD PACK QTY (pcs)
EP0241-000	TE-DS15-CT-11	DS-15	15.3 (390)	7.8 (200)	100	85	150	15	<10	15,730 (70)	35 (48)	13 (330)	0.93	36
EP0242-000	TE-DS28-CT-11	DS-28	25 (635)	12.2 (310)	130	100	190	20	<10	15,730 (70)	35 (48)	17.6 (447)	1.05	18
EP0243-000	TE-DS35-CT-11	DS-35	32.2 (820)	15.7 (400)	175	155	250	30	<10	15,730 (70)	35 (48)	21 (534)	1.14	18
EP0244-000	TE-DS46-CT-11	DS-46	37.2 (945)	18.11 (460)	200	185	280	30	<10	15,730 (70)	35 (48)	23.30 (592)	1.2	18
EP0245-000	TE-DS69-CT-11	DS-69	49.2 (1250)	23.81 (605)	245	225	360	45	<10	15,730 (70)	35 (48)	29 (737)	1.35	18

**End Fitting** - Clevis per ANSI C29.13 (Forged\*)  
Tongue per ANSI C29.13 (Forged\*)

**Round Head Pin** - Galvanized Pin

**Split Pin** - Stainless Steel

**SML (Specified Mechanical Load)** - 15000 Lbs

**Routine Test Load** - 7,500 Lbs

\*Additional end fittings (e.g. Ball, Socket, and others) are available on request.

### Naming Convention

<b>TE-</b>	<b>XXXX-</b>	<b>XX -</b>	<b>XX</b>
Company Designation	ANSI Class	End Fitting	End Fitting Type/ Customisation

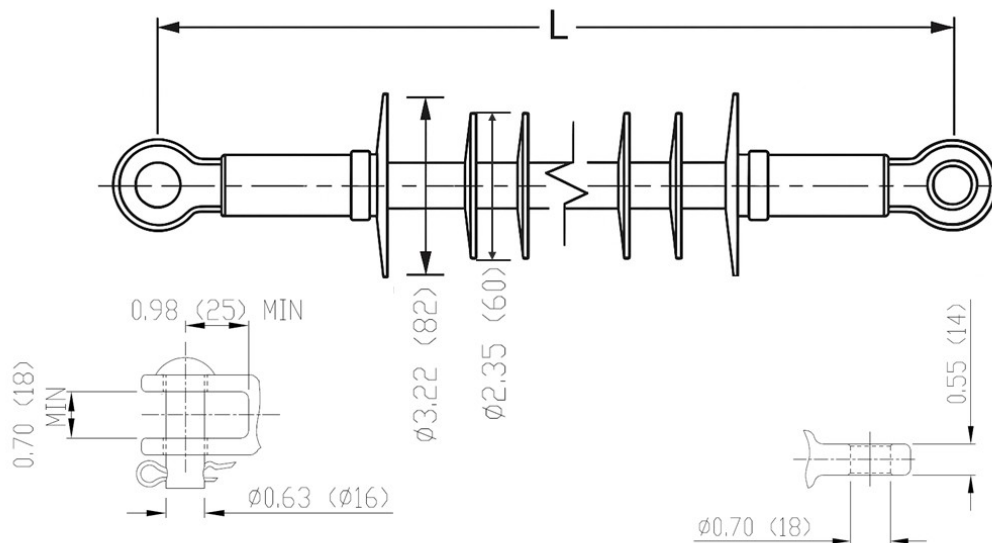

Dimensions inch (mm)

Learn more: [TE.com/energy](https://www.te-connectivity.com/energy)

© 2025 TE Connectivity. All Rights Reserved. EPP-4547-DDS-12/25

TE, TE Connectivity, TE connectivity (logo) and EVERY CONNECTION COUNTS, are trademarks owned or licensed by TE Connectivity. Other logos, product and company names mentioned herein may be trademarks of their respective owners.

While TE has made every reasonable effort to ensure the accuracy of the information in this brochure, TE does not guarantee that it is error-free, nor does TE make any other representation, warranty or guarantee that the information is accurate, correct, reliable or current. TE reserves the right to make any adjustments to the information contained herein at any time without notice. TE Connectivity's obligations shall only be as set forth in TE Connectivity's Standard Terms and Conditions of Sale for this product and in no case will TE Connectivity be liable for any incidental, indirect or consequential damages arising out of the sale, resale, use or misuse of the product. TE expressly disclaims all implied warranties regarding the information contained herein, including, but not limited to, any implied warranties of merchantability or fitness for a particular purpose. The dimensions, specifications, and/or information contained herein are for reference purposes only and are subject to change without notice. Consult TE for the latest dimensions, specifications, and/or information. Users of TE Connectivity products should make their own evaluation to determine the suitability of each such product for the specific application.

Connect with us:

[TE.com/energy-contact](https://www.te-connectivity.com/energy-contact)